

# HOLE SAWS & CORE DRILLS

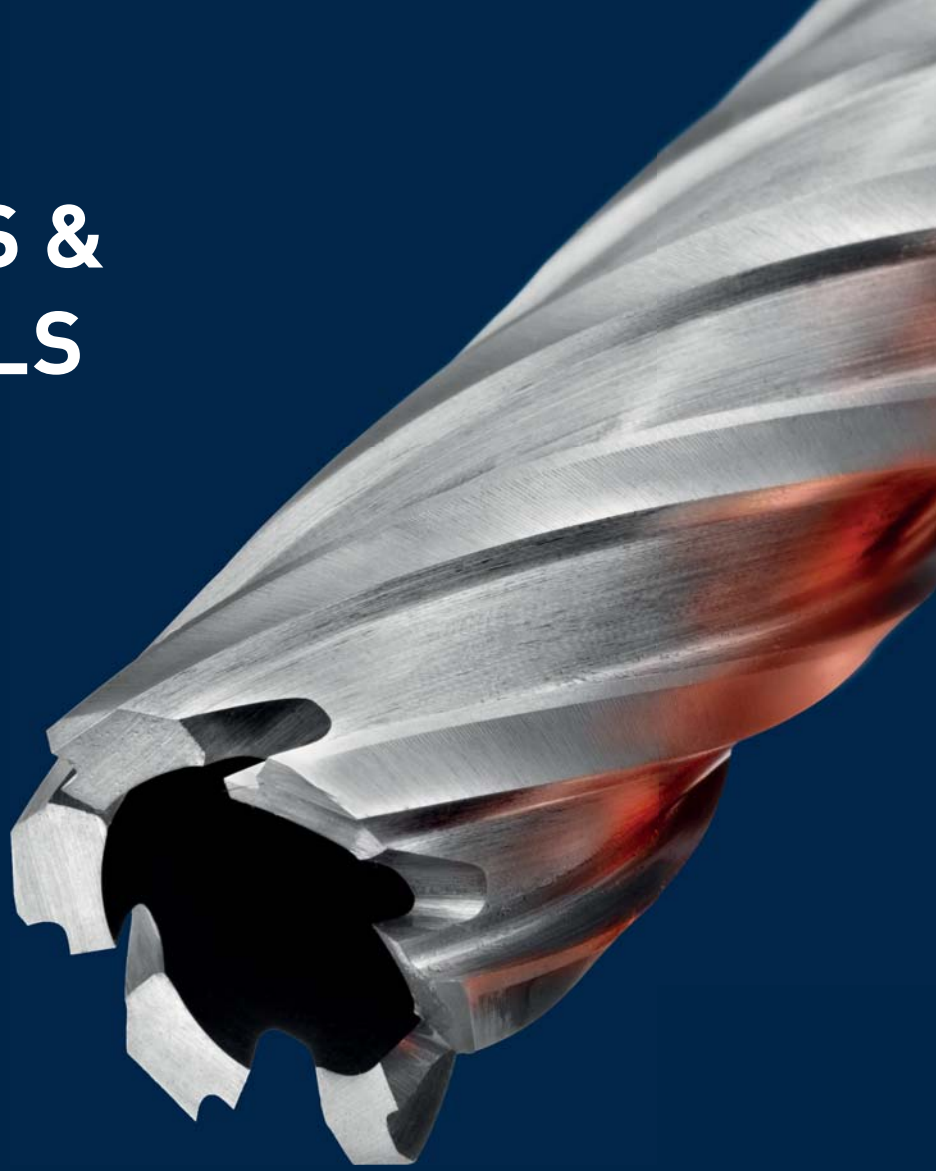

**ROTEC**<sup>®</sup>  
CUTTING TOOLS

## Spindle speeds for HSS annular cutters

| Material   | Steel<br>< 700<br>N/mm <sup>2</sup> | Steel<br>> 700<br>N/mm <sup>2</sup> | Alloyed steel<br>(stainless)<br>< 1.000<br>N/mm <sup>2</sup> | Cast iron<br>< 250 HB | Cast iron<br>> 250 HB | CuZn-alloys<br>(brittle) | CuZn-alloys<br>(soft) | Aluminium<br>alloys<br>< 11% Si | Plastics | Duroplast<br>(Fibre<br>reinforced<br>plastic) |
|------------|-------------------------------------|-------------------------------------|--|-----------------------|-----------------------|--------------------------|-----------------------|---------------------------------|----------|---|
| Vc [m/min] | 30                                  | 25                                  | 20   | 15                    | 10                    | 60                       | 35                    | 30                              | 20       | 15  |
| Diameter   | RPM                                 | RPM                                 | RPM  | RPM                   | RPM                   | RPM                      | RPM                   | RPM                             | RPM      | RPM   |
| ø12        | 796                                 | 663                                 | 531  | 398                   | 265                   | 1592                     | 928                   | 796                             | 531      | 398   |
| ø13        | 735                                 | 612                                 | 490  | 367                   | 245                   | 1469                     | 857                   | 735                             | 490      | 367   |
| ø14        | 682                                 | 568                                 | 455  | 341                   | 227                   | 1364                     | 796                   | 682                             | 455      | 341   |
| ø15        | 637                                 | 531                                 | 424  | 318                   | 212                   | 1273                     | 743                   | 637                             | 424      | 318   |
| ø16        | 597                                 | 497                                 | 398  | 298                   | 199                   | 1194                     | 696                   | 597                             | 398      | 298   |
| ø17        | 562                                 | 468                                 | 374  | 281                   | 187                   | 1123                     | 655                   | 562                             | 374      | 281   |
| ø18        | 531                                 | 442                                 | 354  | 265                   | 177                   | 1061                     | 619                   | 531                             | 354      | 265   |
| ø19        | 503                                 | 419                                 | 335  | 251                   | 168                   | 1005                     | 586                   | 503                             | 335      | 251   |
| ø20        | 477                                 | 398                                 | 318  | 239                   | 159                   | 955                      | 557                   | 477                             | 318      | 239   |
| ø21        | 455                                 | 379                                 | 303  | 227                   | 152                   | 909                      | 531                   | 455                             | 303      | 227   |
| ø22        | 434                                 | 362                                 | 289  | 217                   | 145                   | 868                      | 506                   | 434                             | 289      | 217   |
| ø23        | 415                                 | 346                                 | 277  | 208                   | 138                   | 830                      | 484                   | 415                             | 277      | 208   |
| ø24        | 398                                 | 332                                 | 265  | 199                   | 133                   | 796                      | 464                   | 398                             | 265      | 199   |
| ø25        | 382                                 | 318                                 | 255  | 191                   | 127                   | 764                      | 446                   | 382                             | 255      | 191   |
| ø26        | 367                                 | 306                                 | 245  | 184                   | 122                   | 735                      | 428                   | 367                             | 245      | 184   |
| ø27        | 354                                 | 295                                 | 236  | 177                   | 118                   | 707                      | 413                   | 354                             | 236      | 177   |
| ø28        | 341                                 | 284                                 | 227  | 171                   | 114                   | 682                      | 398                   | 341                             | 227      | 171   |
| ø29        | 329                                 | 274                                 | 220  | 165                   | 110                   | 659                      | 384                   | 329                             | 220      | 165   |
| ø30        | 318                                 | 265                                 | 212  | 159                   | 106                   | 637                      | 371                   | 318                             | 212      | 159   |
| ø31        | 308                                 | 257                                 | 205  | 154                   | 103                   | 616                      | 359                   | 308                             | 205      | 154   |
| ø32        | 298                                 | 249                                 | 199  | 149                   | 99                    | 597                      | 348                   | 298                             | 199      | 149   |
| ø33        | 289                                 | 241                                 | 193  | 145                   | 96                    | 579                      | 338                   | 289                             | 193      | 145   |
| ø34        | 281                                 | 234                                 | 187  | 140                   | 94                    | 562                      | 328                   | 281                             | 187      | 140   |
| ø35        | 273                                 | 227                                 | 182  | 136                   | 91                    | 546                      | 318                   | 273                             | 182      | 136   |
| ø36        | 265                                 | 221                                 | 177  | 133                   | 88                    | 531                      | 309                   | 265                             | 177      | 133   |
| ø37        | 258                                 | 215                                 | 172  | 129                   | 86                    | 516                      | 301                   | 258                             | 172      | 129   |
| ø38        | 251                                 | 209                                 | 168  | 126                   | 84                    | 503                      | 293                   | 251                             | 168      | 126   |
| ø39        | 245                                 | 204                                 | 163  | 122                   | 82                    | 490                      | 286                   | 245                             | 163      | 122   |
| ø40        | 239                                 | 199                                 | 159  | 119                   | 80                    | 477                      | 279                   | 239                             | 159      | 119   |
| ø42        | 227                                 | 189                                 | 152  | 114                   | 76                    | 455                      | 265                   | 227                             | 152      | 114   |
| ø44        | 217                                 | 181                                 | 145  | 109                   | 72                    | 434                      | 253                   | 217                             | 145      | 109   |
| ø46        | 208                                 | 173                                 | 138  | 104                   | 69                    | 415                      | 242                   | 208                             | 138      | 104   |
| ø48        | 199                                 | 166                                 | 133  | 99                    | 66                    | 398                      | 232                   | 199                             | 133      | 99  |
| ø50        | 191                                 | 159                                 | 127  | 95                    | 64                    | 382                      | 223                   | 191                             | 127      | 95  |
| ø52        | 184                                 | 153                                 | 122  | 92                    | 61                    | 367                      | 214                   | 184                             | 122      | 92  |
| ø54        | 177                                 | 147                                 | 118  | 88                    | 59                    | 354                      | 206                   | 177                             | 118      | 88  |
| ø56        | 171                                 | 142                                 | 114  | 85                    | 57                    | 341                      | 199                   | 171                             | 114      | 85  |
| ø58        | 165                                 | 137                                 | 110  | 82                    | 55                    | 329                      | 192                   | 165                             | 110      | 82  |
| ø60        | 159                                 | 133                                 | 106  | 80                    | 53                    | 318                      | 186                   | 159                             | 106      | 80  |

**HOLE SAW TOOTHING**



Variable pitch.  
Number of teeth per inch, ie. 8 to 12 teeth per inch.



Variable pitch.  
Distance between 2 teeth in mm, ie. varying from 2 to 3 mm.

**MATERIALS**



Bi-metal (steel basis + HSS working part) for more tool life.



Bi-metal (steel basis + HSS-Co working part) for even more tool life.



Tungsten Carbide Tipped teeth to increase hardness, cutting speed and tool life.

**GEOMETRIES**



For 90° countersinking applications.

**SHANKS & DRIVES**



Universal shank 19mm (3/4") with WELDON and NITTO clamping system.



Shank 19mm (3/4") with WELDON clamping system.



Cylindrical shank with 3 flats for improved clamping in drill chucks.





**Execution:** BIMCO [Bi-metal with 8%Co alloy], teeth milled, side set. Excellent cutting results in [alloyed] steel and stainless steel due to 8% cobalt alloy base material. Robust design with extra firm lid for more stability. 100% Made in Germany!

**Application:** For sawing holes in most commonly used metals, plastics and woods.  
Material groups: 1.1-1.5 / 1.6 / 2.1 - 2.2 / 2.3 / 3.1 - 3.3 / 4.1 - 4.12

| Diameter [mm] | Diameter [inch] | Depth [mm] | Item nr. | € / pc |
|---------------|-----------------|------------|----------|--------|
| 14,0          | 9/16"           | 38         | 527.0140 | 9,00   |
| 16,0          | 5/8"            | 38         | 527.0160 | 9,00   |
| 17,0          | 11/16"          | 38         | 527.0170 | 9,00   |
| 19,0          | 3/4"            | 38         | 527.0190 | 9,00   |
| 20,0          | -               | 38         | 527.0200 | 9,00   |
| 21,0          | 13/16"          | 38         | 527.0210 | 9,00   |
| 22,0          | 7/8"            | 38         | 527.0220 | 9,20   |
| 23,0          | 19/21"          | 38         | 527.0230 | 9,20   |
| 24,0          | 15/16"          | 38         | 527.0240 | 9,20   |
| 25,0          | 1"              | 38         | 527.0250 | 9,59   |
| 27,0          | 1-1/16"         | 38         | 527.0270 | 9,59   |
| 29,0          | 1-1/8"          | 38         | 527.0290 | 9,84   |
| 30,0          | 1-3/16"         | 38         | 527.0300 | 9,84   |
| 32,0          | 1-1/4"          | 38         | 527.0320 | 9,84   |
| 33,0          | 1-5/16"         | 38         | 527.0330 | 9,84   |
| 35,0          | 1-3/8"          | 38         | 527.0350 | 10,28  |
| 37,0          | 1-7/16"         | 38         | 527.0370 | 10,28  |
| 38,0          | 1-1/2"          | 38         | 527.0380 | 10,28  |
| 40,0          | 1-9/16"         | 38         | 527.0400 | 10,28  |
| 41,0          | 1-5/8"          | 38         | 527.0410 | 10,28  |
| 43,0          | 1-11/16"        | 38         | 527.0430 | 10,28  |
| 44,0          | 1-3/4"          | 38         | 527.0440 | 12,52  |
| 46,0          | 1-13/16"        | 38         | 527.0460 | 12,52  |
| 48,0          | 1-7/8"          | 38         | 527.0480 | 12,52  |
| 51,0          | 2"              | 38         | 527.0510 | 12,52  |
| 52,0          | 2-1/16"         | 38         | 527.0520 | 15,66  |
| 54,0          | 2-1/8"          | 38         | 527.0540 | 15,66  |
| 57,0          | 2-1/4"          | 38         | 527.0570 | 15,66  |
| 58,0          | -               | 38         | 527.0580 | 15,66  |
| 59,0          | 2-5/16"         | 38         | 527.0590 | 15,66  |
| 60,0          | 2-3/8"          | 38         | 527.0600 | 15,66  |

| Diameter [mm] | Diameter [inch] | Depth [mm] | Item nr. | € / pc |
|---------------|-----------------|------------|----------|--------|
| 64,0          | 2-1/2"          | 38         | 527.0640 | 17,03  |
| 65,0          | 2-9/16"         | 38         | 527.0650 | 17,03  |
| 67,0          | 2-5/8"          | 38         | 527.0670 | 17,03  |
| 68,0          | -               | 38         | 527.0680 | 17,03  |
| 70,0          | 2-3/4"          | 38         | 527.0700 | 17,03  |
| 73,0          | 2-7/8"          | 38         | 527.0730 | 17,03  |
| 76,0          | 3"              | 38         | 527.0760 | 17,47  |
| 79,0          | 3-1/8"          | 38         | 527.0790 | 17,47  |
| 83,0          | 3-1/4"          | 38         | 527.0830 | 18,59  |
| 86,0          | 3-3/8"          | 38         | 527.0860 | 19,62  |
| 89,0          | 3-1/2"          | 38         | 527.0890 | 19,82  |
| 92,0          | 3-5/8"          | 38         | 527.0920 | 20,35  |
| 95,0          | 3-3/4"          | 38         | 527.0950 | 21,53  |
| 98,0          | 3-7/8"          | 38         | 527.0980 | 24,76  |
| 102,0         | 4"              | 38         | 527.1020 | 24,76  |
| 105,0         | 4-1/8"          | 38         | 527.1050 | 27,74  |
| 108,0         | 4-1/4"          | 38         | 527.1080 | 35,67  |
| 111,0         | 4-3/8"          | 38         | 527.1110 | 40,46  |
| 114,0         | 4-1/2"          | 38         | 527.1140 | 49,96  |
| 121,0         | 4-3/4"          | 38         | 527.1210 | 54,94  |
| 127,0         | 5"              | 38         | 527.1270 | 60,77  |
| 133,0         | 5-1/4"          | 38         | 527.1330 | 71,29  |
| 140,0         | 5-1/2"          | 38         | 527.1400 | 72,16  |
| 146,0         | 5-3/4"          | 38         | 527.1460 | 79,17  |
| 152,0         | 6"              | 38         | 527.1520 | 83,51  |
| 160,0         | 6-1/3"          | 38         | 527.1600 | 131,36 |
| 168,0         | 6-5/8"          | 38         | 527.1680 | 138,91 |
| 177,0         | 7"              | 38         | 527.1770 | 144,92 |
| 200,0         | 7-14/16"        | 38         | 527.2000 | 156,72 |
| 210,0         | 8-1/4"          | 38         | 527.2100 | 169,02 |

**BiMCo Hole saws, fine pitch (8/12)**



**Execution:** BIMCO [Bi-metal with 8%Co alloy], teeth milled, side set, fine variable pitch [8/12 TPI]. Fine pitched hole saws are preferred on thinner material. Robust design with extra firm lid for more stability. 100% Made in Germany!

**Application:** For sawing holes in most commonly used metals, plastics and woods.  
For thin sheet metals (<2mm) [stainless steel <1mm].  
Material groups: 1.1-1.5 / 1.6 / 2.1 - 2.2 / 2.3 / 3.1 - 3.3 / 4.1 - 4.12

| Diameter [mm] | Diameter [inch] | Depth [mm] | Item nr. | € / pc |
|---------------|-----------------|------------|----------|--------|
| 14,0          | 9/16"           | 38         | 530.5140 | 11,12  |
| 16,0          | 5/8"            | 38         | 530.5160 | 11,08  |
| 17,0          | 11/16"          | 38         | 530.5170 | 11,41  |
| 19,0          | 3/4"            | 38         | 530.5190 | 11,08  |
| 20,0          | 25/32"          | 38         | 530.5200 | 11,08  |
| 21,0          | 13/16"          | 38         | 530.5210 | 11,79  |
| 22,0          | 7/8"            | 38         | 530.5220 | 11,45  |
| 23,0          | 19/21"          | 38         | 530.5230 | 11,79  |
| 24,0          | 15/16"          | 38         | 530.5240 | 12,66  |
| 25,0          | 1"              | 38         | 530.5250 | 11,87  |
| 27,0          | 1-1/16"         | 38         | 530.5270 | 14,92  |
| 29,0          | 1-1/8"          | 38         | 530.5290 | 12,29  |
| 30,0          | 1-3/16"         | 38         | 530.5300 | 14,92  |
| 32,0          | 1-1/4"          | 38         | 530.5320 | 13,53  |
| 35,0          | 1-3/8"          | 38         | 530.5350 | 15,20  |
| 38,0          | 1-1/2"          | 38         | 530.5380 | 15,57  |
| 40,0          | 1-9/16"         | 38         | 530.5400 | 16,46  |
| 41,0          | 1-5/8"          | 38         | 530.5410 | 16,46  |

| Diameter [mm] | Diameter [inch] | Depth [mm] | Item nr. | € / pc |
|---------------|-----------------|------------|----------|--------|
| 43,0          | 1-11/16"        | 38         | 530.5430 | 19,00  |
| 44,0          | 1-3/4"          | 38         | 530.5440 | 17,24  |
| 46,0          | 1-13/16"        | 38         | 530.5460 | 17,66  |
| 48,0          | 1-7/8"          | 38         | 530.5480 | 18,45  |
| 51,0          | 2"              | 38         | 530.5510 | 17,24  |
| 54,0          | 2-1/8"          | 38         | 530.5540 | 21,14  |
| 57,0          | 2-1/4"          | 38         | 530.5570 | 22,25  |
| 60,0          | 2-3/8"          | 38         | 530.5600 | 23,50  |
| 64,0          | 2-1/2"          | 38         | 530.5640 | 25,91  |
| 65,0          | 2-9/16"         | 38         | 530.5650 | 26,14  |
| 68,0          | -               | 38         | 530.5680 | 27,25  |
| 70,0          | 2-3/4"          | 38         | 530.5700 | 27,86  |
| 73,0          | 2-7/8"          | 38         | 530.5730 | 28,74  |
| 76,0          | 3"              | 38         | 530.5760 | 29,25  |
| 83,0          | 3-1/4"          | 38         | 530.5830 | 30,68  |
| 86,0          | 3-3/8"          | 38         | 530.5860 | 31,80  |
| 92,0          | 3-5/8"          | 38         | 530.5920 | 34,02  |
| 98,0          | 3-7/8"          | 38         | 530.5980 | 36,58  |

| Diameter [mm] | Diameter [inch] | Depth [mm] | Item nr. | € / pc |
|---------------|-----------------|------------|----------|--------|
| 105,0         | 4-1/8"          | 38         | 530.6105 | 42,68  |
| 108,0         | 4-1/4"          | 38         | 530.6108 | 44,50  |

| Diameter [mm] | Diameter [inch] | Depth [mm] | Item nr. | € / pc |
|---------------|-----------------|------------|----------|--------|
| 114,0         | 4-1/2"          | 38         | 530.6114 | 47,88  |
| 127,0         | 5"              | 38         | 530.6127 | 56,69  |

**Quick-Lock Adapters**



| Nr. | Description   | Drive    | Range     | Item nr. | € / pc |
|-----|---------------|----------|-----------|----------|--------|
| 1   | Quick Adapter | HEX 9    | 14-30 mm  | 527.3020 | 12,95  |
| 2   | Quick Adapter | HEX 9    | 32-210 mm | 527.3021 | 18,75  |
| 3   | Quick Adapter | SDS-plus | 14-30 mm  | 527.3030 | 14,50  |
| 4   | Quick Adapter | SDS-plus | 32-210 mm | 527.3031 | 19,50  |



**Execution:** Pilot drill bits for Quick-Lock Adapter.  
**Application:** Piloting hole sawing applications with Rotec BiMCo hole saws (series 527).

| Nr. | Description         | Hole saws | Length | Item nr. | € / pc |
|-----|---------------------|-----------|--------|----------|--------|
| 1   | HSS Pilot drill bit | 527.xxxx  | 90mm   | 527.3023 | 3,50   |
| 2   | HSS Pilot drill bit | 528.xxxx  | 110mm  | 527.3024 | 3,95   |
| 3   | TCT Pilot drill bit | 528.xxxx  | 110mm  | 527.3025 | 3,95   |

| Description      | Shank | Length | Item nr. | € / pc |
|------------------|-------|--------|----------|--------|
| <b>Extension</b> | HEX 9 | 300 mm | 527.3040 | 17,00  |

**BiMCo hole saw sets (4/6) with Quick-Lock**



| Description                                     | Type  | Content  | Item nr. | € / set |
|---|-------|--|----------|---------|
| 10 piece set HSS-Bi-Co8 hole saws "Plumber"     | "527" | 1x ø19, 22, 27, 32, 35, 40, 51 and 64mm<br>1x Quick-Lock adapter 14-30mm (HEX 9)<br>1x Quick-Lock adapter 32-210mm (HEX 9)                 | 527.4105 | 125,00  |
| 10 piece set HSS-Bi-Co8 hole saws "Electrician" | "527" | 1x ø22, 27, 32, 35, 38, 44, 51, 68 and 76mm<br>1x Quick-Lock adapter 14-30mm (HEX 9)<br>1x Quick-Lock adapter 32-210mm (HEX 9)             | 527.4110 | 139,00  |
| 14 piece set HSS-Bi-Co8 hole saws "Allround"    | "527" | 1x ø19, 22, 25, 32, 35, 38, 44, 51, 57, 64, 68 and 76mm<br>1x Quick-Lock adapter 14-30mm (HEX 9)<br>1x Quick-Lock adapter 32-210mm (HEX 9) | 527.4125 | 209,00  |

**Quick-Change starter kits**



**Execution:** **Change hole saws within seconds at the push of a button!!**  
The patented Quick-Change system can, if the right accessories are used, be used on almost all types of hole saws!

**Application:** Both kits have one arbor (either with hexagon 8.5mm or hexagon 11mm shank), one HSS pilot drill bit and two adapters (1x 1/2"x20 UNF for ø14-30mm and 1x 5/8"x18 UNF for ø32-210mm).

| Description           | Shank   | Pilot drill | Item nr. | € / set      |
|-----------------------|---------|-------------|----------|--------------|
| <b>QC Starter-kit</b> | HEX 8.5 | HSS         | 527.3106 | <b>29,95</b> |
| <b>QC Starter-kit</b> | HEX 11  | HSS         | 527.3111 | <b>29,95</b> |

**Quick-Change holders**



**Execution:** Quick-Change arbors with hexagon shank and Quick-Change connection for Rotec multi-purpose hole saws (series 527) in combination with the relevant Quick-Change adapters (not included). One HSS pilot drill bit (527.3150) is included.

| Description         | Shank   | Pilot drill | Item nr. | € / pc       |
|---------------------|---------|-------------|----------|--------------|
| <b>Quick change</b> | HEX 8.5 | HSS         | 527.3105 | <b>27,50</b> |
| <b>Quick change</b> | HEX 11  | HSS         | 527.3110 | <b>26,91</b> |



**Execution:** HSS Pilot drill bit for Quick-Change arbors.

**Application:** Piloting hole sawing applications with Rotec hole saws (series 527).

| Description            | Item nr. | € / pc      |
|------------------------|----------|-------------|
| <b>Pilot drill bit</b> | 527.3150 | <b>4,25</b> |



**Execution:** Quick-Change adapters for hole saws.

**Application:** Adapter to use hole saws with the patented Quick-Change system. Sold separately or in (bulk) packs.

| Description    | Opname      | PU | Item nr. | € / pack     |
|----------------|-------------|----|----------|--------------|
| <b>Adapter</b> | 1/2"-20 UNF | 1  | 528.3155 | <b>2,30</b>  |
| <b>Adapter</b> | 1/2"-20 UNF | 5  | 528.3156 | <b>9,98</b>  |
| <b>Adapter</b> | 1/2"-20 UNF | 10 | 528.3157 | <b>19,43</b> |
| <b>Adapter</b> | 5/8"-18 UNF | 1  | 528.3160 | <b>2,57</b>  |
| <b>Adapter</b> | 5/8"-18 UNF | 5  | 528.3161 | <b>9,98</b>  |
| <b>Adapter</b> | 5/8"-18 UNF | 10 | 528.3162 | <b>19,43</b> |



| Description                                     | Type  | Content  | Item nr. | € / set       |
|---|-------|--|----------|---------------|
| 13 pc set BIMCO Hole saws "Electrician", HEX 11 | "527" | 1x ø22, 27, 32, 35, 38, 44, 51, 60, 68 and 76mm<br>1x Quick-Change holder (HEX 11)<br>2x HSS Pilot drill                         | 527.5105 | <b>195,00</b> |
| 13 pc set BIMCO Hole saws "Electrician", SDS+   | "527" | 1x ø22, 27, 32, 35, 38, 44, 51, 60, 68 and 76mm<br>1x Quick-Change holder (SDS+)<br>2x HSS Pilot drill                           | 527.6105 | <b>205,00</b> |
| 16 pc set BIMCO Hole saws "Allround", HEX 11    | "527" | 1x ø19, 22, 25, 32, 35, 38, 44, 51, 57, 60, 64, 68 and 76mm<br>1x Quick-Change holder (HEX 11)<br>2x HSS Pilot drill             | 527.5110 | <b>225,00</b> |
| 16 pc set BIMCO Hole saws "Allround", SDS+      | "527" | 1x ø19, 22, 25, 32, 35, 38, 44, 51, 57, 60, 64, 68 and 76mm<br>1x Quick-Change holder (SDS+)<br>2x HSS Pilot drill               | 527.6110 | <b>239,00</b> |
| 19 pc set BIMCO Hole saws "MAX", HEX 11         | "527" | 1x ø19, 22, 25, 29, 32, 35, 38, 44, 51, 57, 60, 64, 68, 76, 83 and 92mm<br>1x Quick-Change holder (HEX 11)<br>2x HSS Pilot drill | 527.5115 | <b>269,00</b> |
| 19 pc set BIMCO Hole saws "MAX", SDS+           | "527" | 1x ø19, 22, 25, 29, 32, 35, 38, 44, 51, 57, 60, 64, 68, 76, 83 and 92mm<br>1x Quick-Change holder (SDS+)<br>2x HSS Pilot drill   | 527.6115 | <b>279,00</b> |





**Execution:** Stable built hole saw with carbide tipped teeth, cuts up to 5 times faster than traditional hole saws. Maximum cutting depth up to 57mm.

**Application:** For effortless hole making applications in all kinds of softwood, hardwood, particle boards, MDF, (fibre reinforced) plastics like PVC, nylon and epoxy, aerated concrete, bricks, soft stones and tiles (max. core hardness of 6).

| Diameter [mm] | Diameter [inch] | Depth [mm] | Item nr. | € / pc |
|---------------|-----------------|------------|----------|--------|
| 14,0          | 9/16            | 57         | 528.0140 | 9,24   |
| 16,0          | 5/8             | 57         | 528.0160 | 9,24   |
| 17,0          | 11/16           | 57         | 528.0170 | 9,24   |
| 19,0          | 3/4             | 57         | 528.0190 | 9,24   |
| 20,0          | 25/32           | 57         | 528.0200 | 9,24   |
| 21,0          | 13/16           | 57         | 528.0210 | 9,24   |
| 22,0          | 7/8             | 57         | 528.0220 | 9,24   |
| 24,0          | 15/16           | 57         | 528.0240 | 9,24   |
| 25,0          | 1               | 57         | 528.0250 | 9,24   |
| 27,0          | 1.1/16          | 57         | 528.0270 | 9,84   |
| 28,0          | 1-1/8           | 57         | 528.0280 | 9,84   |
| 29,0          | 1-1/8           | 57         | 528.0290 | 9,84   |
| 30,0          | 1-3/16          | 57         | 528.0300 | 9,84   |
| 32,0          | 1-1/4           | 57         | 528.0320 | 9,84   |
| 33,0          | 1-5/16          | 57         | 528.0330 | 10,79  |
| 35,0          | 1-3/8           | 57         | 528.0350 | 10,79  |
| 37,0          | 1-7/16          | 57         | 528.0370 | 10,79  |
| 38,0          | 1-1/2           | 57         | 528.0380 | 10,79  |
| 40,0          | 1-9/16          | 57         | 528.0400 | 11,90  |
| 41,0          | 1-5/8           | 57         | 528.0410 | 13,27  |
| 43,0          | 1-11/16         | 57         | 528.0430 | 13,27  |
| 44,0          | 1-3/4           | 57         | 528.0440 | 13,27  |
| 46,0          | 1-13/16         | 57         | 528.0460 | 13,27  |
| 48,0          | 1-7/8           | 57         | 528.0480 | 13,27  |
| 51,0          | 2               | 57         | 528.0510 | 13,52  |
| 52,0          | 2-1/16          | 57         | 528.0520 | 13,52  |
| 54,0          | 2-1/8           | 57         | 528.0540 | 16,09  |
| 57,0          | 2-1/4           | 57         | 528.0570 | 16,18  |
| 59,0          | 2-5/16          | 57         | 528.0590 | 16,18  |
| 60,0          | 2-3/8           | 57         | 528.0600 | 16,18  |
| 64,0          | 2-1/2           | 57         | 528.0640 | 17,72  |

| Diameter [mm] | Diameter [inch] | Depth [mm] | Item nr. | € / pc |
|---------------|-----------------|------------|----------|--------|
| 65,0          | 2-9/16          | 57         | 528.0650 | 17,72  |
| 67,0          | 2-5/8           | 57         | 528.0670 | 17,80  |
| 68,0          | 2-11/16         | 57         | 528.0680 | 17,80  |
| 70,0          | 2-3/4           | 57         | 528.0700 | 17,80  |
| 73,0          | 2-7/8           | 57         | 528.0730 | 17,80  |
| 76,0          | 3               | 57         | 528.0760 | 19,69  |
| 79,0          | 3-1/8           | 57         | 528.0790 | 19,69  |
| 80,0          |                 | 57         | 528.0800 | 19,69  |
| 82,0          |                 | 57         | 528.0820 | 19,69  |
| 83,0          | 3-1/4           | 57         | 528.0830 | 20,12  |
| 86,0          | 3-3/8           | 57         | 528.0860 | 23,11  |
| 89,0          | 3-1/2           | 57         | 528.0890 | 23,11  |
| 92,0          | 3-5/8           | 57         | 528.0920 | 23,11  |
| 95,0          | 3-3/4           | 57         | 528.0950 | 24,91  |
| 98,0          | 3-1/2           | 57         | 528.0980 | 26,62  |
| 102,0         | 4               | 57         | 528.1020 | 27,73  |
| 105,0         | 4-1/8           | 57         | 528.1050 | 28,68  |
| 108,0         | 4-1/4           | 57         | 528.1080 | 36,55  |
| 111,0         | 4-3/8           | 57         | 528.1110 | 40,32  |
| 114,0         | 4-1/2           | 57         | 528.1140 | 46,14  |
| 121,0         | 4-3/4           | 57         | 528.1210 | 47,08  |
| 125,0         |                 | 57         | 528.1250 | 53,67  |
| 127,0         | 5               | 57         | 528.1270 | 56,41  |
| 133,0         | 5-1/4           | 57         | 528.1330 | 64,03  |
| 140,0         | 5-1/2           | 57         | 528.1400 | 67,20  |
| 152,0         | 6               | 57         | 528.1520 | 71,39  |
| 160,0         | 6-19/64         | 57         | 528.1600 | 82,18  |
| 165,0         | 6-1/2           | 57         | 528.1650 | 82,18  |
| 168,0         | 6-39/64         | 57         | 528.1680 | 87,57  |
| 178,0         | 7               | 57         | 528.1780 | 96,90  |
| 200,0         | 7-7/8           | 57         | 528.2000 | 118,21 |

**Quick-Change starter kits (HSS)**



**Execution:** Both kits have one arbor (hex. 8.5mm or hex. 11mm shank), one HSS pilot drill bit and two adapters (1x 1/2"x20 UNF for ø14-30mm and 1x 5/8"x18 UNF for ø32-210mm).

| Description          | Drive   | Item nr. | € / set |
|----------------------|---------|----------|---------|
| QC Starter-kit (HSS) | HEX 8.5 | 528.3116 | 31,45   |
| QC Starter-kit (HSS) | HEX 11  | 528.3101 | 31,45   |

**Quick-Change starter kits (TCT)**



**Execution:** Both kits have one arbor (HEX 8.5mm or HEX 11mm shank), one carbide tipped pilot drill bit and two adapters (1x 1/2"x20 UNF for ø14-30mm and 1x 5/8"x18 UNF for ø32-210mm).

| Description          | Drive   | Item nr. | € / set |
|----------------------|---------|----------|---------|
| QC Starter-kit (TCT) | HEX 8.5 | 528.3121 | 31,45   |
| QC Starter-kit (TCT) | HEX 11  | 528.3106 | 31,45   |

**Quick-Change holders (HSS)**



**Execution:** Quick-Change arbors with hexagon shank and Quick-Change connection for Rotec multi-purpose hole saws (series 528) in combination with the relevant Quick-Change adapters (not included). One HSS pilot drill bit (528.3145) is included.

| Description               | Drive   | Item nr. | € / pc       |
|---------------------------|---------|----------|--------------|
| <b>Quick-Change arbor</b> | HEX 8.5 | 528.3115 | <b>26,20</b> |
| <b>Quick-Change arbor</b> | HEX 11  | 528.3100 | <b>26,20</b> |

**Quick-Change pilot drill (HSS)**



**Execution:** HSS Pilot drill bit for Quick-Change arbors.  
**Application:** For piloting hole sawing applications with Rotec multi-purpose hole saws (series 528).

| Description                | Item nr. | € / pc      |
|----------------------------|----------|-------------|
| <b>HSS Pilot drill bit</b> | 528.3145 | <b>3,68</b> |

**Quick-Change holders (TCT)**



**Execution:** Quick-Change arbors with hexagon shank and Quick-Change connection for Rotec multi-purpose hole saws (series 528) in combination with the relevant Quick-Change adapters (not included). One carbide tipped pilot drill bit (528.3140) is included.

| Description               | Drive   | Item nr. | € / pc       |
|---------------------------|---------|----------|--------------|
| <b>Quick-Change arbor</b> | HEX 8.5 | 528.3120 | <b>26,20</b> |
| <b>Quick-Change arbor</b> | HEX 11  | 528.3105 | <b>26,20</b> |

**Quick-Change pilot drill (TCT)**



**Execution:** Tungsten carbide tipped (TCT) HSS Pilot drill bit for Quick-Change arbors.  
**Application:** For piloting hole sawing applications with Rotec multi-purpose hole saws (series 528).

| Description                | Item nr. | € / pc      |
|----------------------------|----------|-------------|
| <b>TCT Pilot drill bit</b> | 528.3140 | <b>2,84</b> |



**Execution:** Quick-Change adapters for hole saws.  
**Application:** Adapter to use hole saws with the patented Quick-Change system. Sold separately or in (bulk) packs.

| Description    | Opname      | PU | Item nr. | € / pack     |
|----------------|-------------|----|----------|--------------|
| <b>Adapter</b> | 1/2"-20 UNF | 1  | 528.3155 | <b>2,30</b>  |
| <b>Adapter</b> | 1/2"-20 UNF | 5  | 528.3156 | <b>9,98</b>  |
| <b>Adapter</b> | 1/2"-20 UNF | 10 | 528.3157 | <b>19,43</b> |
| <b>Adapter</b> | 5/8"-18 UNF | 1  | 528.3160 | <b>2,57</b>  |
| <b>Adapter</b> | 5/8"-18 UNF | 5  | 528.3161 | <b>9,98</b>  |
| <b>Adapter</b> | 5/8"-18 UNF | 10 | 528.3162 | <b>19,43</b> |



|  | Type  | Content  | Item nr. | € / set       |
|--|-------|--|----------|---------------|
| 13 pc set MP hole saws "Plumber", HEX 11mm     | "528" | 1x ø22, 27, 32, 35, 38, 44, 51, 60, 68 and 76mm<br>1x Quick-Change holder (HEX 11)<br>1x HSS Pilot drill bit<br>1x TCT Pilot drill bit                         | 528.4105 | <b>204,75</b> |
| 13 pc set MP hole saws "Plumber", SDS+         | "528" | 1x ø22, 27, 32, 35, 38, 44, 51, 60, 68 and 76mm<br>1x Quick-Change holder (SDS+)<br>1x HSS Pilot drill bit<br>1x TCT Pilot drill bit                           | 528.6105 | <b>219,45</b> |
| 16 pc set MP hole saws "Electrician", HEX 11mm | "528" | 1x ø19, 22, 25, 32, 35, 38, 44, 51, 57, 60, 64, 68 and 76mm<br>1x Quick-Change holder (HEX 11)<br>1x HSS Pilot drill bit<br>1x TCT Pilot drill bit             | 528.4110 | <b>236,25</b> |
| 16 pc set MP hole saws "Electrician", SDS+     | "528" | 1x ø19, 22, 25, 32, 35, 38, 44, 51, 57, 60, 64, 68 and 76mm<br>1x Quick-Change holder (SDS+)<br>1x HSS Pilot drill bit<br>1x TCT Pilot drill bit               | 528.6110 | <b>250,95</b> |
| 19 pc set MP hole saws "Allround", HEX 11mm    | "528" | 1x ø19, 22, 25, 29, 32, 35, 38, 44, 51, 57, 60, 64, 68, 76, 83 and 92mm<br>1x Quick-Change holder (HEX 11)<br>1x HSS Pilot drill bit<br>1x TCT Pilot drill bit | 528.4115 | <b>282,45</b> |
| 19 pc set MP hole saws "Allround", SDS+        | "528" | 1x ø19, 22, 25, 29, 32, 35, 38, 44, 51, 57, 60, 64, 68, 76, 83 and 92mm<br>1x Quick-Change holder (SDS+)<br>1x HSS Pilot drill bit<br>1x TCT Pilot drill bit   | 528.6115 | <b>299,25</b> |

**528**

**TCT MP Hole saws, 165mm**



**Execution:** Stable built hole saw with carbide tipped teeth, cuts up to 5 times faster than traditional hole saws. Maximum cutting depth up to 165mm.

**Application:** For effortless hole making applications in all kinds of softwood, hardwood, particle boards, MDF, (fibre reinforced) plastics like PVC, nylon and epoxy, aerated concrete, bricks, soft stones and tiles (max. core hardness of 6).

| Diameter [mm] | Diameter [inch] | Depth [mm] | Item nr. | € / pc       |
|---------------|-----------------|------------|----------|--------------|
| <b>45,0</b>   | -               | 165        | 528.7045 | <b>45,71</b> |
| <b>51,0</b>   | 2"              | 165        | 528.7051 | <b>53,47</b> |
| <b>60,0</b>   | 2-3/8"          | 165        | 528.7060 | <b>62,70</b> |
| <b>65,0</b>   | 2-9/16"         | 165        | 528.7065 | <b>74,44</b> |
| <b>68,0</b>   | 2-11/16"        | 165        | 528.7068 | <b>75,73</b> |
| <b>70,0</b>   | 2-3/4"          | 165        | 528.7070 | <b>77,56</b> |
| <b>75,0</b>   | -               | 165        | 528.7075 | <b>84,51</b> |
| <b>80,0</b>   | 3-5/32"         | 165        | 528.7080 | <b>90,17</b> |
| <b>86,0</b>   | 3-3/8"          | 165        | 528.7086 | <b>92,26</b> |

| Diameter [mm] | Diameter [inch] | Depth [mm] | Item nr. | € / pc        |
|---------------|-----------------|------------|----------|---------------|
| <b>92,0</b>   | 3-5/8"          | 165        | 528.7092 | <b>95,23</b>  |
| <b>102,0</b>  | 4"              | 165        | 528.7102 | <b>104,01</b> |
| <b>111,0</b>  | 4-3/8"          | 165        | 528.7111 | <b>118,67</b> |
| <b>121,0</b>  | 4-3/4"          | 165        | 528.7121 | <b>141,59</b> |
| <b>130,0</b>  | 5-1/8"          | 165        | 528.7130 | <b>167,16</b> |
| <b>140,0</b>  | 5-1/2"          | 165        | 528.7140 | <b>188,10</b> |
| <b>152,0</b>  | 6"              | 165        | 528.7152 | <b>194,60</b> |
| <b>160,0</b>  | 6-19/64"        | 165        | 528.7160 | <b>253,76</b> |
| <b>210,0</b>  | 7-7/8"          | 165        | 528.7210 | <b>528,54</b> |

529

**BiMCo Roofers' pipe hole saws, 300mm (4/6)**

**ROTEC®**



PATENT PENDING

**Execution:** BIMCO (Bi-metal with 8%Co alloy), roofers' pipe hole saw with variable pitch (4/6 TPI) and 1/2"-14 BSP(G) connection. Supplied with hexagon shank adapter (779.0050) and pilot auger bit (240.2001). Can also be used with HSS twisted drill bit (160.1203) as pilot drill (sold separately).

**Application:** For sawing fast and precise holes (for exhaust pipes of heating systems or waste air pipes in sanitary systems) in most commonly used materials. Not suited for abrasive materials, stone and concrete.

| Diameter [mm] | max. depth [mm] | Item nr. | € / pc |
|---------------|-----------------|----------|--------|
| 85            | 300             | 529.0852 | 207,98 |
| 110           | 300             | 529.1102 | 261,41 |
| 121           | 300             | 529.1212 | 281,44 |
| 130           | 300             | 529.1302 | 299,00 |
| 140           | 300             | 529.1402 | 341,54 |
| 152           | 300             | 529.1522 | 374,93 |
| 160           | 300             | 529.1602 | 388,29 |
| 170           | 300             | 529.1702 | 421,68 |
| 200           | 300             | 529.2002 | 475,10 |

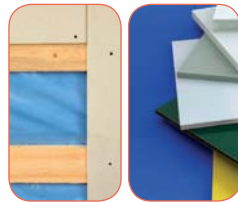

PATENT PENDING

**Execution:** BIMCO (Bi-metal with 8%Co alloy), roofers' pipe hole saw with variable pitch (4/6 TPI) and 1/2"-14 BSP(G) connection. Supplied with hexagon shank adapter (779.0050) and pilot auger bit (240.2000).

**Application:** For sawing fast and precise holes (for exhaust pipes of heating systems or waste air pipes in sanitary systems) in (sloped) roofs. Not suited for abrasive materials, stone and concrete.

| Diameter [mm] | max. depth [mm] | Item nr. | € / pc |
|---------------|-----------------|----------|--------|
| 85            | 150             | 529.0851 | 201,31 |
| 110           | 150             | 529.1101 | 254,73 |
| 121           | 150             | 529.1211 | 274,76 |
| 130           | 150             | 529.1301 | 294,80 |
| 140           | 150             | 529.1401 | 328,19 |
| 152           | 150             | 529.1521 | 361,58 |
| 160           | 150             | 529.1601 | 374,93 |
| 170           | 150             | 529.1701 | 401,65 |
| 200           | 150             | 529.2001 | 455,07 |

**TCT Roofers' pipe hole saws, 300mm**

**ROTEC®**



**Execution:** TCT Construction pipe hole saws were specifically developed for making holes quickly and efficiently in (sloping) roofs made of wood and insulation materials. Drills effortlessly double the number of holes than any other existing models and in less than half the time! Equipped with M16 connection type.

**Application:** For drilling holes in (sloping) roofs for mounting ventilation and exhaust pipes. Not suited for drilling in metals and abrasive materials such as stone and concrete.

| Diameter [mm] | Depth [mm] | Item nr. | € / pc |
|---------------|------------|----------|--------|
| 80            | 300        | 529.6080 | 228,00 |
| 100           | 300        | 529.6100 | 276,00 |
| 110           | 300        | 529.6110 | 297,60 |
| 130           | 300        | 529.6130 | 350,00 |
| 150           | 300        | 529.6150 | 420,00 |
| 160           | 300        | 529.6160 | 460,80 |
| 170           | 300        | 529.6170 | 484,12 |
| 200           | 300        | 529.6200 | 547,20 |

Construction pipe hole saws, 300mm (3/4)



PATENT PENDING



**Execution:** BIMCO (Bi-metal wit 8%Co alloy), construction pipe hole saw with variable pitch (3/4 TPI) and 1/2"-14 BSP(G) connection. Supplied with hexagon shank adapter (779.0050) and pilot auger bit (240.2001). Can also be used with HSS twisted drill bit (160.1203) as pilot drill (sold separately).

**Application:** For sawing fast and precise holes in wood.  
**PS: As soon as the hole saw has penetrated about 1cm into the wood, the pilot drill bit has to be removed before sawing is resumed.**

| Diameter [mm] | max. depth [mm] | Item nr. | € / pc |
|---------------|-----------------|----------|--------|
| 85            | 300             | 529.4085 | 207,98 |
| 110           | 300             | 529.4110 | 261,41 |
| 130           | 300             | 529.4130 | 309,67 |
| 152           | 300             | 529.4152 | 374,93 |



PATENT PENDING



**Execution:** BIMCO (Bi-metal wit 8%Co alloy), construction pipe hole saw with variable pitch (3/4 TPI) and 1/2"-14 BSP(G) connection. Supplied with hexagon shank adapter (779.0050) and pilot auger bit (240.2000).

**Application:** For sawing fast and precise holes in wood.  
**PS: As soon as the hole saw has penetrated about 1cm into the wood, the pilot drill bit has to be removed before sawing is resumed.**

| Diameter [mm] | max. depth [mm] | Item nr. | € / pc |
|---------------|-----------------|----------|--------|
| 85            | 150             | 529.3085 | 201,31 |
| 110           | 150             | 529.3110 | 254,73 |
| 130           | 150             | 529.3130 | 294,80 |
| 152           | 150             | 529.3152 | 361,58 |

Ventilation pipe hole saws, 100mm (8/12)



PATENT PENDING



**Execution:** BIMCO (Bi-metal wit 8%Co alloy), ventilation pipe hole saw with variable pitch (8/12 TPI) and 1/2"-14 BSP(G) connection. Supplied with hexagon shank adapter (779.0050) and pilot auger bit (240.2000).

**Application:** Due to the fine variable pitched toothing excellent results in plastic pipes and aircondition/ventilation ducts.

| Diameter [mm] | max. depth [mm] | Item nr. | € / pc |
|---------------|-----------------|----------|--------|
| 85            | 100             | 529.5085 | 201,31 |
| 110           | 100             | 529.5110 | 254,73 |
| 130           | 100             | 529.5130 | 294,80 |
| 143           | 100             | 529.5143 | 338,86 |
| 152           | 100             | 529.5152 | 361,58 |
| 160           | 100             | 529.5160 | 374,93 |
| 178           | 100             | 529.5178 | 415,00 |
| 180           | 100             | 529.5180 | 418,99 |
| 200           | 100             | 529.5200 | 455,07 |
| 217           | 100             | 529.5217 | 481,78 |
| 221           | 100             | 529.5221 | 488,46 |

**Special pipe hole saws (4/6)**

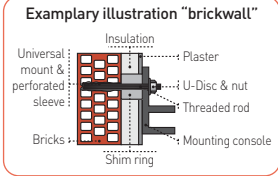
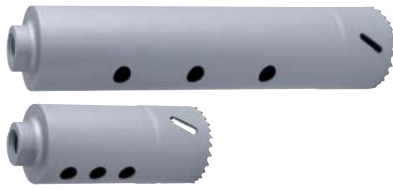

**Execution:** BIMCO (Bi-metal wit 8%Co alloy), special hole saw with variable pitch (4/6 TPI) and M16 connection for the facade building industry. Hexagon shank adapter (769.0002) is not included!

**Application:** For making centre holes for spacer sleeves in insulation material for a technical correct installation of facades on buildings (refer to drawing).

| Diameter [mm] | max. depth [mm] | Item nr. | € / pc |
|---------------|-----------------|----------|--------|
| 51            | 100             | 529.7511 | 138,52 |
| 51            | 250             | 529.7512 | 123,86 |

**PATENT PENDING**

**Roller shutter hole saws, wood (4/6)**



**Execution:** BIMCO (Bi-metal wit 8%Co alloy), roller shutter hole saw with variable pitch (4/6 TPI) and M16 connection. Supplied with hexagon shank adapter (769.0002) and pilot drill bit (150.0700). Coated with PTFE to reduce friction and to protect from rusting.

**Application:** For making holes in wooden window frames in order to feed through the belt of roller shutters.

| Diameter [mm] | max. depth [mm] | Item nr. | € / pc |
|---------------|-----------------|----------|--------|
| 17,0          | 90              | 529.0170 | 121,80 |
| 25,0          | 90              | 529.0240 | 121,80 |

**PATENT PENDING**

**Roller shutter hole saws, plastic (8/12)**



**Execution:** BIMCO (Bi-metal wit 8%Co alloy), roller shutter hole saw with variable pitch (8/12 TPI) and M16 connection. Supplied with hexagon shank adapter (769.0002) and pilot drill bit (150.0700). Coated with PTFE to reduce friction and to protect from rusting.

**Application:** For making holes in plastic window frames in order to feed through the belt of roller shutters.

| Diameter [mm] | max. depth [mm] | Item nr. | € / pc |
|---------------|-----------------|----------|--------|
| 17,0          | 90              | 529.0517 | 113,15 |
| 19,0          | 90              | 529.0519 | 113,15 |
| 22,0          | 90              | 529.0522 | 113,15 |

**PATENT PENDING**

**Adapters**



| From     | To                   | Item nr. | € / pc |
|----------|----------------------|----------|--------|
| HEX 12.7 | M16 (ext.)           | 769.0002 | 11,00  |
| HEX 12.7 | 1/2" - 14 BSP (int.) | 779.0050 | 33,80  |

**Adjustable hole saws**



**Execution:** Adjustable hole saw, complete in a case

**Application:** For sawing holes in wood, plastics, gypsum and aluminium. Ideal for installing spotlights.

| Diameter range | max. depth | Item nr. | € / pc |
|----------------|------------|----------|--------|
| ø30 - 163 mm   | 23 mm      | 529.8163 | 181,88 |
| ø30 - 260 mm   | 23 mm      | 529.8260 | 229,83 |
| ø37 - 300 mm   | 23 mm      | 529.8300 | 245,03 |

**Execution:** Spare blades for adjustable hole saws.

| Description                          | Item nr. | € / pc |
|--------------------------------------|----------|--------|
| HSS blade for wood                   | 529.8990 | 25,20  |
| Tungsten carbide blade for aluminium | 529.8991 | 25,20  |

**534**

**TCT Hole saws 11mm**

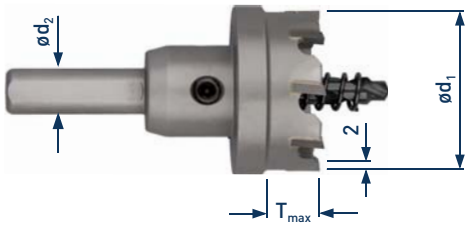

**Execution:** Tungsten carbide tipped hole saw. Thin cutting width of only 2mm results in low cutting forces, therefore ideal for handheld (cordless) power tools, even up to diameter 150mm! Supplied with fixed arbor, exchangeable pilot drill bit (1 pc) and ejector spring (1 pc).

**Application:** Steels and stainless steels, max. 5 mm depth of cut. Non-ferrous materials like (fibre reinforced) plastics, aluminium, sandwich panels up to maximum depth of 11mm (remove ejector spring). If applied on thicker materials, remove chips every 2-3 mm depth of cut.

For all metals: use only a good cutting oil.

| ød <sub>1</sub> [mm] | T <sub>max</sub> [mm] | ød <sub>2</sub> [mm] | Item nr.  | € / pc       |
|----------------------|-----------------------|----------------------|-----------|--------------|
| 14,0                 | 11                    | 10                   | 534.0140R | <b>35,55</b> |
| 16,0                 | 11                    | 10                   | 534.0160R | <b>35,55</b> |
| 18,0                 | 11                    | 10                   | 534.0180R | <b>35,55</b> |
| 20,0                 | 11                    | 10                   | 534.0200R | <b>35,55</b> |
| 22,0                 | 11                    | 10                   | 534.0220R | <b>35,55</b> |
| 25,0                 | 11                    | 10                   | 534.0250R | <b>35,55</b> |
| 30,0                 | 11                    | 10                   | 534.0300R | <b>35,55</b> |

| ød <sub>1</sub> [mm] | T <sub>max</sub> [mm] | ød <sub>2</sub> [mm] | Item nr.  | € / pc       |
|----------------------|-----------------------|----------------------|-----------|--------------|
| 32,0                 | 11                    | 10                   | 534.0320R | <b>35,79</b> |
| 35,0                 | 11                    | 10                   | 534.0350R | <b>35,79</b> |
| 40,0                 | 11                    | 10                   | 534.0400R | <b>42,45</b> |
| 45,0                 | 11                    | 10                   | 534.0450R | <b>43,35</b> |
| 50,0                 | 11                    | 10                   | 534.0500R | <b>47,94</b> |
| 60,0                 | 11                    | 10                   | 534.0600R | <b>57,60</b> |

**Pilot drill bits**



| Dimensions | Hole saws | Item nr.  | € / pc     |
|------------|-----------|-----------|------------|
| ø6 x 48    | 534.xxxxR | 534.9030R | <b>N/B</b> |

**535R TCT Hole saws 26mm**

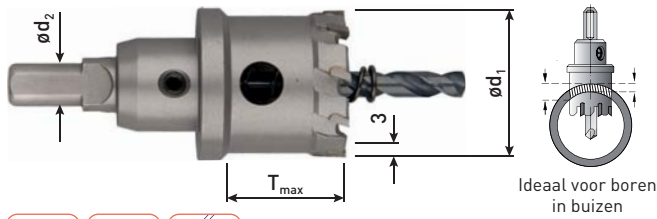

**Execution:** Tungsten carbide tipped hole saw with super heavy duty body and 3.0mm cutting width. For use in handheld power tools (up to  $\varnothing 40$ ) and stationary machines (drill presses, magnetic core drills). Supplied with fixed arbor, exchangeable pilot drill bit (1 pc) and ejector spring (1 pc).

**Application:** Steels and stainless steels, max. 15 mm depth of cut. Non-ferrous materials like (fibre reinforced) plastics, aluminium, sandwich panels up to maximum depth of 26mm (remove ejector spring). If applied on thicker materials, remove chips whenever necessary. For flat materials, tubes and curved surfaces. Drilling with overlap is no problem.

For all metals: use only a good cutting oil.

| $\varnothing d_1$ [mm] | $T_{max}$ [mm] | $\varnothing d_2$ [mm] | Item nr.  | € / pc |
|------------------------|----------------|------------------------|-----------|--------|
| 16,0                   | 26             | 10                     | 535.0160R | 50,70  |
| 17,0                   | 26             | 10                     | 535.0170R | 50,70  |
| 18,0                   | 26             | 10                     | 535.0180R | 50,70  |
| 19,0                   | 26             | 10                     | 535.0190R | 50,70  |
| 20,0                   | 26             | 10                     | 535.0200R | 50,70  |
| 21,0                   | 26             | 10                     | 535.0210R | 50,70  |
| 22,0                   | 26             | 10                     | 535.0220R | 50,70  |
| 23,0                   | 26             | 10                     | 535.0230R | 50,70  |
| 24,0                   | 26             | 10                     | 535.0240R | 50,70  |
| 25,0                   | 26             | 10                     | 535.0250R | 50,70  |
| 26,0                   | 26             | 10                     | 535.0260R | 50,70  |
| 27,0                   | 26             | 10                     | 535.0270R | 50,70  |
| 28,0                   | 26             | 10                     | 535.0280R | 50,70  |
| 29,0                   | 26             | 10                     | 535.0290R | 50,70  |
| 30,0                   | 26             | 10                     | 535.0300R | 50,85  |
| 31,0                   | 26             | 10                     | 535.0310R | 50,85  |
| 32,0                   | 26             | 10                     | 535.0320R | 50,85  |
| 33,0                   | 26             | 10                     | 535.0330R | 50,85  |
| 34,0                   | 26             | 10                     | 535.0340R | 50,85  |
| 35,0                   | 26             | 10                     | 535.0350R | 50,85  |
| 36,0                   | 26             | 10                     | 535.0360R | 50,85  |

| $\varnothing d_1$ [mm] | $T_{max}$ [mm] | $\varnothing d_2$ [mm] | Item nr.  | € / pc |
|------------------------|----------------|------------------------|-----------|--------|
| 37,0                   | 26             | 10                     | 535.0370R | 50,85  |
| 38,0                   | 26             | 10                     | 535.0380R | 50,85  |
| 39,0                   | 26             | 10                     | 535.0390R | 50,85  |
| 40,0                   | 26             | 10                     | 535.0400R | 55,85  |
| 41,0                   | 26             | 10                     | 535.0410R | 55,65  |
| 42,0                   | 26             | 10                     | 535.0420R | 55,65  |
| 43,0                   | 26             | 10                     | 535.0430R | 55,65  |
| 44,0                   | 26             | 10                     | 535.0440R | 55,80  |
| 45,0                   | 26             | 10                     | 535.0450R | 55,80  |
| 50,0                   | 26             | 10                     | 535.0500R | 56,70  |
| 55,0                   | 26             | 10                     | 535.0550R | 57,39  |
| 60,0                   | 26             | 10                     | 535.0600R | 68,55  |
| 65,0                   | 26             | 10                     | 535.0650R | 75,69  |
| 70,0                   | 26             | 10                     | 535.0700R | 86,34  |
| 75,0                   | 26             | 10                     | 535.0750R | 92,34  |
| 80,0                   | 26             | 13                     | 535.0800R | 100,74 |
| 85,0                   | 26             | 13                     | 535.0850R | 112,59 |
| 90,0                   | 26             | 13                     | 535.0900R | 115,35 |
| 95,0                   | 26             | 13                     | 535.0950R | 121,80 |
| 100,0                  | 26             | 13                     | 535.1000R | 123,45 |

**Pilot drill bits**



| Dimensions                | For hole saws | Item nr.  | € / pc |
|---------------------------|---------------|-----------|--------|
| $\varnothing 6 \times 76$ | 535.xxxxR     | 535.9030R | N/B    |



**538**

**HSS twisted drill bits with weldon-shank**

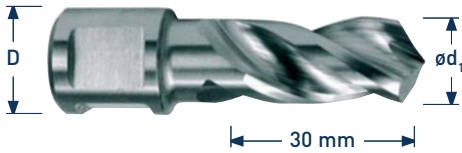

**Execution:** HSS-G solid drill bits, 3 fully CBN ground cutting edges and flutes for extremely stable drilling. Easy to regrind! With WELDON 19mm shank.

**Application:** For magnetic core drills or drill presses with either WELDON-type spindle mount or morse taper spindle mount in conjunction with an appropriate adaptor.  
For drilling in most commonly used materials such as construction steels, mild steels and alloyed steels.

| Diameter [mm] | Depth [mm] | Shank [mm] | Item nr. | € / pc       |
|---------------|------------|------------|----------|--------------|
| 10,0          | 30         | Weldon 19  | 538.9010 | <b>42,94</b> |
| 11,0          | 30         | Weldon 19  | 538.9011 | <b>51,25</b> |
| 12,0          | 30         | Weldon 19  | 538.9012 | <b>51,25</b> |

| Diameter [mm] | Depth [mm] | Shank [mm] | Item nr. | € / pc       |
|---------------|------------|------------|----------|--------------|
| 13,0          | 30         | Weldon 19  | 538.9013 | <b>52,14</b> |
| 14,0          | 30         | Weldon 19  | 538.9014 | <b>52,66</b> |
| 15,0          | 30         | Weldon 19  | 538.9015 | <b>54,66</b> |

**HSS-G COUNTERSINKS weldon shank**

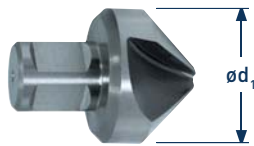

**Execution:** HSS-G countersinks, 90°, CBN ground cutting edges and flutes for extremely stable countersinking/chamfering applications. With WELDON 19mm shank.

**Application:** For magnetic core drills or drill presses with either WELDON-type spindle mount or morse taper spindle mount in conjunction with an appropriate adaptor.  
For drilling in most commonly used materials such as construction steels, mild steels and alloyed steels.

| Diameter [mm] | Length | Shank [mm] | Item nr. | € / pc        |
|---------------|--------|------------|----------|---------------|
| 25            | 43     | Weldon 19  | 538.9325 | <b>51,45</b>  |
| 30            | 47     | Weldon 19  | 538.9330 | <b>64,84</b>  |
| 40            | 52     | Weldon 19  | 538.9340 | <b>92,66</b>  |
| 55            | 63     | Weldon 19  | 538.9355 | <b>172,20</b> |



**Technical specifications:**

|                          |  |
|--------------------------|--|
| Motor / total power      | 1.000 Watt / 1.050 Watt                  |
| Voltage(s)               | 220-240V @ 50-60Hz<br>110-120V @ 50-60Hz |
| Spindle speed            | 775 rpm (idle) / 400 rpm (max. load)     |
| Spindle rotation         | right hand rotation only                 |
| Spindle mount            | WELDON 19mm                              |
| Stroke length            | 150 mm                                   |
| Machine L x W x H        | 255 x 210 x 370-512 mm                   |
| Magn. foot L x W x H     | 160 x 80 x 42 mm                         |
| Magnetic adhesion        | 1.500 kgs / 14.715 N                     |
| Weight                   | 12 kgs                                   |
| <b>Working capacity:</b> |  |
| Annular cutters          | ø12 - 32 mm                              |
| Drill bits               | ø1 - 13 mm                               |

| Type   | Item nr. | € / pc |
|--|----------|--------|
| Magnetic core drilling machine RTC 32 + case | 906.0032 | 625,00 |

RTC 50 R/L



**Technical specifications:**

|                          |   |
|--------------------------|---|
| Motor / total power      | 1.250 Watt / 1.375 Watt   |
| Voltage(s)               | 220-240V @ 50-60Hz<br>110-120V @ 50-60Hz  |
| Spindle speeds           | (I) 100 - 280 rpm (idle) 250 rpm (max. load)<br>(II) 185 - 530 rpm (idle) 460 rpm (max. load) |
| Spindle rotation         | right and left hand rotation  |
| Spindle mount            | Morse taper 2 (MT 2)  |
| Stroke length            | 170 mm  |
| Machine L x W x H        | 321 x 210 x 385-550 mm  |
| Magn. foot L x W x H     | 170 x 85 x 48 mm  |
| Magnetic adhesion        | 1.850 kgs / 18.150 N  |
| Weight                   | 14 kgs  |
| <b>Working capacity:</b> |   |
| Annular cutters          | ø12 - 50 mm   |
| Drill bits               | ø1 - 23 mm  |
| Tapping                  | M3 - M20  |
| Countersinking           | ø10 - 40 mm   |

| Type   | Item nr. | € / pc  |
|--|----------|---------|
| Magnetic core drilling machine RTC 50 R/L + case | 906.0050 | 1025,00 |

RTC 100 R/L



**Technical specifications:**

|                          |   |
|--------------------------|---|
| Motor / total power      | 1.900 Watt / 2.050 Watt   |
| Voltage(s)               | 220-240V @ 50-60Hz<br>110-120V @ 50-60Hz  |
| Spindle speeds           | (I) 42 - 110 rpm (idle) 85 rpm (max. load)<br>(II) 64 - 190 rpm (idle) 152 rpm (max. load)<br>(III) 140 - 400 rpm (idle) 270 rpm (max. load)<br>(IV) 220 - 620 rpm (idle) 480 rpm (max. load) |
| Spindle rotation         | right and left hand rotation  |
| Spindle mount            | Morse taper 3 (MT 3)  |
| Stroke length            | 260 mm  |
| Machine L x W x H        | 365 x 310 x 510-710 mm  |
| Magn. foot L x W x H     | 220 x 110 x 64 mm   |
| Magnetic adhesion        | 3.000 kgs / 29.400 N  |
| Weight                   | 28 kgs  |
| <b>Working capacity:</b> |   |
| Annular cutters          | ø12 - 100 mm  |
| Drill bits               | ø1 - 32 mm  |
| Tapping                  | M3 - M30  |
| Countersinking           | ø10 - 50 mm   |

| Type  | Item nr. | € / pc  |
|---|----------|---------|
| Magnetic core drilling machine RTC 100 R/L + case | 906.0100 | 1425,00 |



**Execution:** Steel hole punchers for hand use , 3 point cut lead, without and with ball-bearing (BB).

**Application:** For punching holes in steel (up to 3mm) and stainless steel (up to 1mm).

| Diameter [mm] | PG/MF       | Screw | Item nr. | € / pc       |
|---------------|-------------|-------|----------|--------------|
| 12,7          | M12/PG 7    | MF 8  | 590.1270 | <b>34,63</b> |
| 12,7 BB       | M12/PG 7    | MF 8  | 590.1271 | <b>33,69</b> |
| 15,2          | PG 9        | MF 10 | 590.1520 | <b>34,63</b> |
| 15,2 BB       | PG 9        | MF 10 | 590.1521 | <b>58,97</b> |
| 16,0          | -           | MF 10 | 590.1600 | <b>34,63</b> |
| 16,0 BB       | -           | MF 10 | 590.1601 | <b>58,97</b> |
| 16,5          | M16         | MF 10 | 590.1650 | <b>36,24</b> |
| 16,5 BB       | M16         | MF 10 | 590.1651 | <b>60,82</b> |
| 18,6          | PG 11       | MF 10 | 590.1860 | <b>38,82</b> |
| 18,6 BB       | PG 11       | MF 10 | 590.1861 | <b>63,40</b> |
| 20,4          | M20/PG 13,5 | MF 10 | 590.2040 | <b>38,82</b> |
| 20,4 BB       | M20/PG 13,5 | MF 10 | 590.2041 | <b>63,40</b> |
| 22,5          | PG 16       | MF 10 | 590.2250 | <b>42,41</b> |
| 22,5 BB       | PG 16       | MF 10 | 590.2251 | <b>66,93</b> |
| 25,0          | -           | MF 10 | 590.2500 | <b>46,59</b> |
| 25,0 BB       | -           | MF 10 | 590.2501 | <b>70,92</b> |
| 25,4          | M25         | MF 10 | 590.2540 | <b>46,59</b> |
| 25,4 BB       | M25         | MF 10 | 590.2541 | <b>70,92</b> |
| 28,3          | PG 21       | MF 12 | 590.2830 | <b>46,59</b> |
| 28,3 BB       | PG 21       | MF 12 | 590.2831 | <b>70,92</b> |
| 32,0          | -           | MF 12 | 590.3200 | <b>51,68</b> |

| Diameter [mm] | PG/MF  | Screw | Item nr. | € / pc        |
|---------------|--------|-------|----------|---------------|
| 32,0 BB       | -      | MF 12 | 590.3201 | <b>76,22</b>  |
| 32,5          | M32/PG | -     | 590.3250 | <b>59,55</b>  |
| 32,5 BB       | M32    | MF 12 | 590.3251 | <b>84,03</b>  |
| 35,0          | -      | MF 12 | 590.3500 | <b>59,55</b>  |
| 35,0 BB       | -      | MF 12 | 590.3501 | <b>84,03</b>  |
| 37,0          | PG 29  | MF 12 | 590.3700 | <b>59,55</b>  |
| 37,0 BB       | PG 29  | MF 12 | 590.3701 | <b>84,03</b>  |
| 38,0          | -      | MF 12 | 590.3800 | <b>59,55</b>  |
| 38,0 BB       | -      | MF 12 | 590.3801 | <b>84,03</b>  |
| 40,5          | M40    | MF 16 | 590.4050 | <b>81,56</b>  |
| 40,5 BB       | M40    | MF 16 | 590.4051 | <b>111,72</b> |
| 47,0          | PG 36  | MF 16 | 590.4700 | <b>96,86</b>  |
| 47,0 BB       | PG 36  | MF 16 | 590.4701 | <b>127,07</b> |
| 50,5          | M50    | MF 16 | 590.5050 | <b>116,58</b> |
| 50,5 BB       | M50    | MF 16 | 590.5051 | <b>153,49</b> |
| 54,0          | PG 42  | MF 16 | 590.5400 | <b>126,20</b> |
| 54,0 BB       | PG 42  | MF 16 | 590.5401 | <b>163,40</b> |
| 60,0          | PG 48  | MF 16 | 590.6000 | <b>156,07</b> |
| 60,0 BB       | PG 48  | MF 16 | 590.6001 | <b>193,27</b> |
| 63,5          | M63    | MF 16 | 590.6350 | <b>179,43</b> |
| 63,5 BB       | M63    | MF 16 | 590.6351 | <b>216,64</b> |

**Drawbolts**



**Execution:** Draw bolts for hole punchers for hand use. Suffix "BB" means draw bolts with ball-bearing.

| Thread type   | Length | Class | Item nr. | € / pc       |
|---------------|--------|-------|----------|--------------|
| MF 8x1,0      | 40     | 10.9  | 590.9005 | <b>1,55</b>  |
| MF10x1,0      | 45     | 12.9  | 590.9010 | <b>2,43</b>  |
| MF12x1,5      | 55     | 12.9  | 590.9015 | <b>2,92</b>  |
| MF16x1,5      | 60     | 12.9  | 590.9020 | <b>3,98</b>  |
| MF10x1,0 (BB) | 50     | 12.9  | 590.9025 | <b>26,91</b> |
| MF12x1,5 (BB) | 60     | 12.9  | 590.9030 | <b>33,03</b> |
| MF16x1,5 (BB) | 70     | 12.9  | 590.9035 | <b>40,32</b> |



**Execution:** Premium type steel hole punchers with split for hand and hydraulic use. Greasing the drawbolt extends tool life and avoids tool seizure.

**Application:** For punching holes in steel (up to 3mm) and stainless steel (up to 1 mm).

| Diameter [mm] | PG/MF    | Drawbolt (hand use) | Drawbolt (hydraulic use) | Item nr. | € / pc        |
|---------------|----------|---------------------|--------------------------|----------|---------------|
| 12,5          | M12      | ø9,5 x 50,0         | ø19,0 x ø9,5             | 591.1250 | <b>51,00</b>  |
| 15,2          | PG9      | ø9,5 x 50,0         | ø19,0 x ø9,5             | 591.1520 | <b>53,50</b>  |
| 16,2          | M16      | ø9,5 x 50,0         | ø19,0 x ø9,5             | 591.1620 | <b>54,50</b>  |
| 18,6          | PG11     | ø9,5 x 50,0         | ø19,0 x ø9,5             | 591.1860 | <b>54,50</b>  |
| 20,4          | M20/PG13 | ø9,5 x 50,0         | ø19,0 x ø9,5             | 591.2040 | <b>54,50</b>  |
| 22,5          | PG16     | ø9,5 x 50,0         | ø19,0 x ø9,5             | 591.2250 | <b>57,00</b>  |
| 25,4          | M25      | ø9,5 x 50,0         | ø19,0 x ø9,5             | 591.2540 | <b>67,50</b>  |
| 28,3          | PG21     | ø9,5 x 50,0         | ø19,0 x ø9,5             | 591.2830 | <b>69,00</b>  |
| 30,5          | M30      | ø9,5 x 50,0         | ø19,0 x ø9,5             | 591.3050 | <b>69,50</b>  |
| 32,5          | M32      | ø19,0 x 55,0        | ø19,0                    | 591.3250 | <b>77,00</b>  |
| 37,0          | PG29     | ø19,0 x 55,0        | ø19,0                    | 591.3700 | <b>82,50</b>  |
| 40,5          | M40      | ø19,0 x 75,0        | ø19,0                    | 591.4050 | <b>87,00</b>  |
| 47,0          | PG36     | ø19,0 x 75,0        | ø19,0                    | 591.4700 | <b>121,00</b> |
| 50,5          | M50      | ø19,0 x 75,0        | ø19,0                    | 591.5050 | <b>151,00</b> |
| 54,0          | PG42     | ø19,0 x 75,0        | ø19,0                    | 591.5400 | <b>152,50</b> |
| 60,0          | PG48     | ø19,0 x 75,0        | ø19,0                    | 591.6000 | <b>157,50</b> |
| 63,5          | M63      | ø19,0 x 75,0        | ø19,0                    | 591.6350 | <b>179,50</b> |

**Drawbolts (for hole punchers with split)**



**Application:** ø6,0 : for use on mild steel sheets up to 1.5mm in thickness  
 ø9,5 : for use on mild steel sheets up to 2.0mm in thickness  
 ø19,0 : for use on mild steel sheets up to 3.0mm in thickness

| Diameter [mm] | Length | Puncher diam. | Item nr. | € / pc       |
|---------------|--------|---------------|----------|--------------|
| 9,5           | 50,0   | 12,5 - 30,5   | 591.9020 | <b>17,00</b> |
| 19,0          | 55,0   | 32,5 - 37,0   | 591.9030 | <b>39,00</b> |
| 19,0          | 75,0   | 40,5 - 63,5   | 591.9040 | <b>45,00</b> |

**Drawbolts (hydraulic)**



| Diameter [mm] | Puncher diam. | Use       | Item nr. | € / pc       |
|---------------|---------------|-----------|----------|--------------|
| ø19,0 x 9,5   | 15,2 - 30,5   | Hydraulic | 591.9550 | <b>47,10</b> |
| ø19,0         | 32,5 - 63,5   | Hydraulic | 591.9560 | <b>62,10</b> |